

Hydraulic speed/feed controls from ACE are maintenance-free, self-contained sealed units for precise control of speed in both directions of travel. The travel speed can be adjusted independently in each direction of travel. Applications include pick and place, machine slides and guards, flaps and hoods etc. The wide variety of mounting accessories make the DVC easy to install on many different types of application.

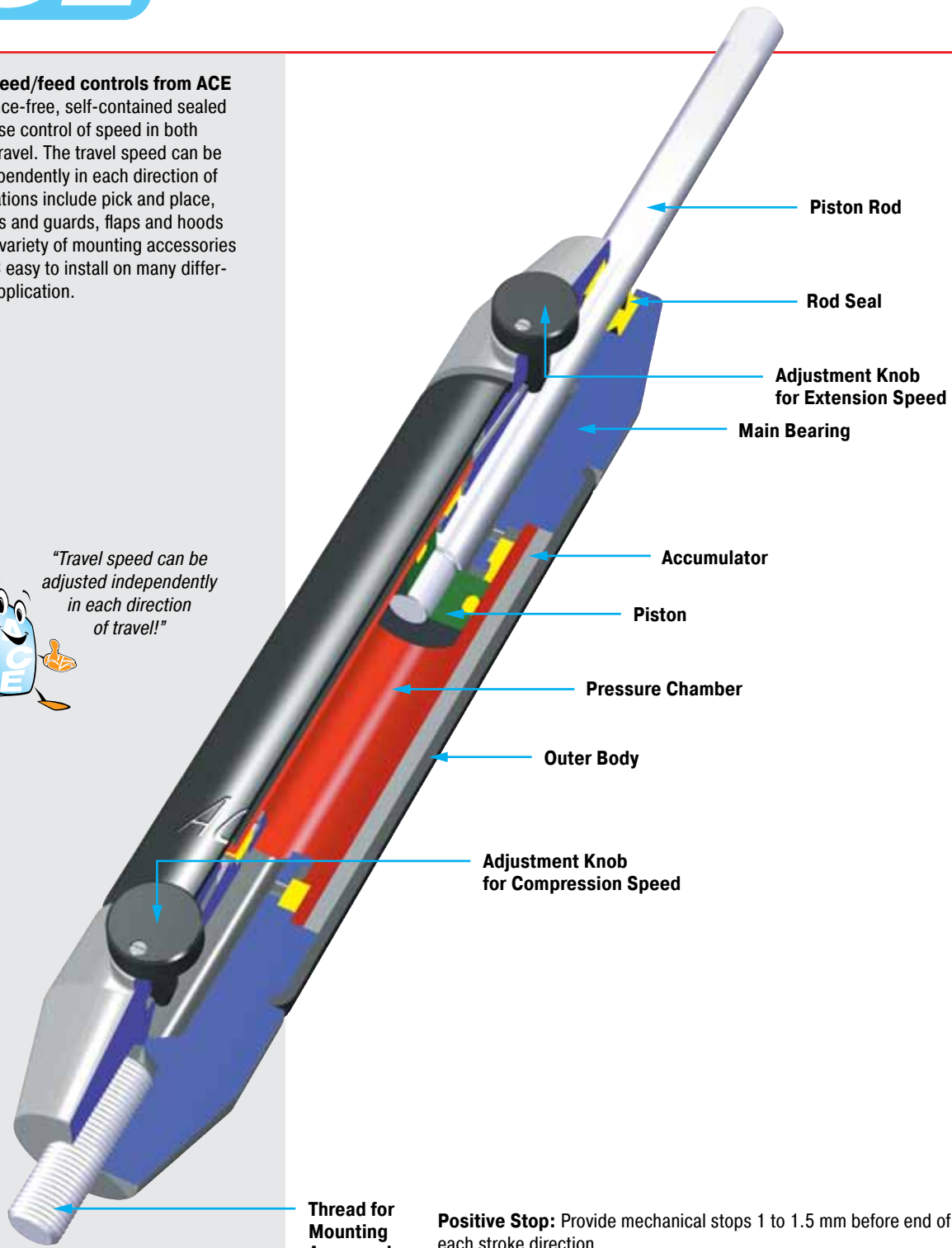
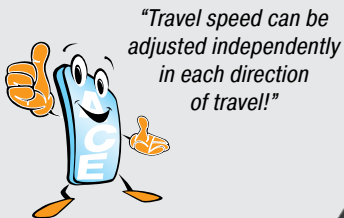

**Positive Stop:** Provide mechanical stops 1 to 1.5 mm before end of each stroke direction.

**Operating fluid:** Automatic Transmission Fluid (ATF) viscosity 42 cSt. at 40 °C

**Material:** Body: Black anodised aluminium. Piston rod: Hard chrome plated steel. End fittings: Zinc plated steel.

**Note:** If unit has not moved for some time the seals may dry causing an increased break-away force on the initial cycle.

**Mounting:** In any position. End fittings must be positively secured to prevent unscrewing.

**Operating temperature range:** 0 °C to 65 °C

**On request:** Special oils and external finishes. Uni-directional damping (free flow in reverse direction).



### End Fitting

### Standard Dimensions

### End Fitting

**A8**

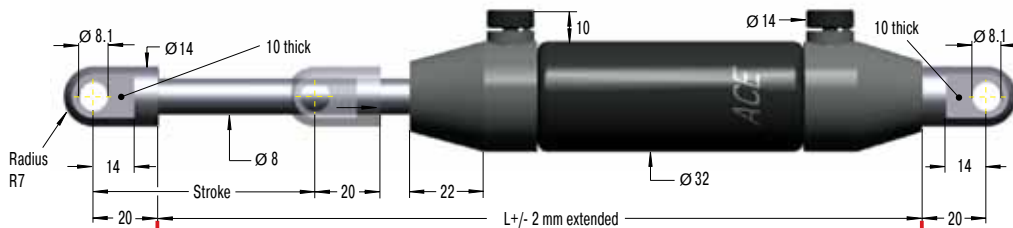

**Eye A8**  
max. force 3000 N

**B8**



### Dimensions

Type	Stroke mm	A max	B	L	Propelling Force N			
					Extension min	Extension max	Compression min	Compression max
DVC-32-50EU	50			240	42	2 000	42	2 000
DVC-32-50EU-XX	50	250	75.2		42	2 000	42	2 000
DVC-32-100EU	100			340	42	2 000	42	1 670
DVC-32-100EU-XX	100	350	124.4		42	2 000	42	1 670
DVC-32-150EU	150			440	42	2 000	42	1 335
DVC-32-150EU-XX	150	450	173.6		42	2 000	42	1 335

**Stud Thread B8**

**C8**

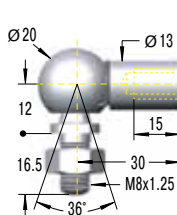

**Angle Ball Joint C8**  
max. force 1200 N

**D8**

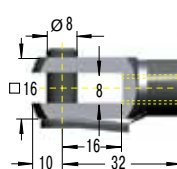

**Clevis Fork D8**  
max. force 3000 N

**E8**

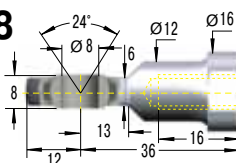

**Swivel Eye E8**  
max. force 3000 N

### Ordering Example

**DVC-32-50EU-DD-P**

Type (Hydraulic Damper) \_\_\_\_\_  
 Body Ø (32 mm) \_\_\_\_\_  
 Stroke (50 mm) \_\_\_\_\_  
 EU Compliant \_\_\_\_\_  
 Piston Rod End Fitting D8 \_\_\_\_\_  
 Body End Fitting D8 \_\_\_\_\_  
 Damping Direction (P = both directions) \_\_\_\_\_

### Damping Options

P = Damping in both directions (standard model)  
 M = Damping on out stroke only (adjustment knob at "rear end" free flow)  
 N = Damping on in stroke only (adjustment knob at "piston rod end" free flow)

The end fittings are interchangeable and must be positively secured by the customer to prevent unscrewing (i.e. Loctite). For mounting accessories see page 200.

### Fixed End Fitting -XX

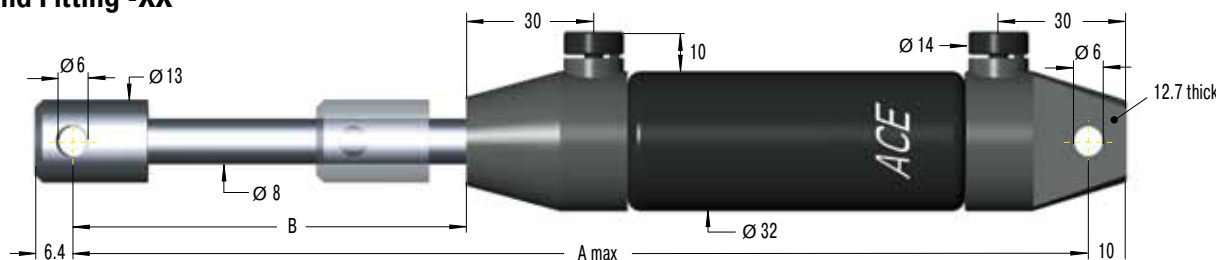

### Compression Speed Control Chart

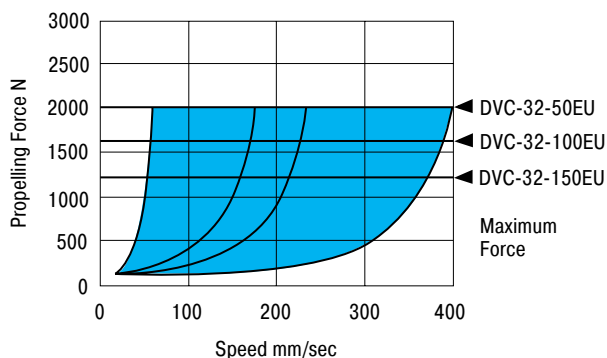

### Tension Speed Control Chart

